

G3 Pro

Revolutionary 3-in-1 Contactless Palm Recognition Terminal

Compatible with
ZKPro Security

Compatible with
BioTime 8.0



G3 Pro is powered by Computer Vision technology like 3-in-1 contactless palm recognition, which means the terminal can perform bio-authentication with a user's palm vein, palm print, and the shape of palm at the same time once the sensor detects a hand presented.

Palm vein and palm print patterns are reliable human identifiers as the details are extremely hard to be duplicated, thus, together with the powerful algorithm, users may enjoy the terminal's enhanced anti-spoofing ability.

Eliminating hygienic concerns, G3 Pro, equipped with a novel hand tracking technique allowing angle tolerance as wide as $\pm 60^\circ$ in the roll axis, the huge capacity of 6,000 palm templates, and a 1.4GHz quad-core CPU, extracts palm print and vein pattern for analysis at a distance for recognition from 0.2m to 0.5m in less than 0.35s. Users no longer need to struggle to touch the sensor at a specific angle and align the center of the palm with the center of the input sensor for proper hand images to be acquired.

Features



Modern Design & Interactive UI



Revolutionary SilkID Fingerprint Sensor



Multiple Verification Modes:
Face / Fingerprint / Palm / Card / Password



Outstanding Performance With Dry, Wet and Rough Fingers



Simple Management & Scalability

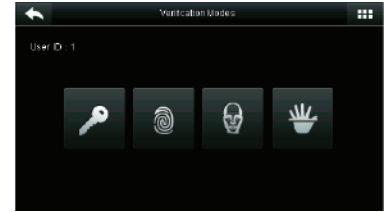
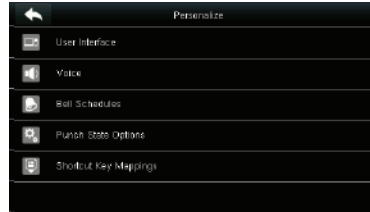
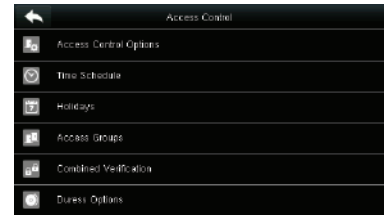

Specifications (G: GL Exclusive Feature)

Capacity

Fingerprints	20,000
G Faces	12,000
G Palm	6,000
Cards	20,000
Transactions	200,000

Hardware

- G 1.4GHz Quad Core CPU
- G Memory 1G RAM / 1G Flash
- SilkID Fingerprint Sensor
- G 4.3 Inches Touch Screen
- Hi-Fi Voice & Indicator
- Tamper Switch Alarm

Optional Functions

- HID Proxy / Mifare Card Reader
- G Wi-Fi / 3G
- External Printer
- G Battery (2,000 mAh)
- G POE (Standard IEEE 802.3at)

Communication

- TCP/IP
- USB Host
- Wiegand Output

Standard Functions

- ID Card / Work Code / WDMS
- DST / SMS / Bell Schedule
- Attendance Status Auto-Switch
- Record Query / Photo ID
- Custom Wallpaper & Screen Saver

Compatibility

- BioTime8.0
- ZKBioSecurity (T&A)
- WDMS

Access Control Interface

- Lock Relay Output
- Alarm Output
- Exit Button
- Door Sensor
- External Bell

Special Functions

- G Multiple Biometric Verification Modes
- G Alive Face / Palm Detection
- G Duplicate Face / Palm Detection

Additional Info

- Working Temperature: 0 °C ~ 45 °C
- Dimensions: 199.2 × 171.8 × 96.9 mm
- Algorithms: ZKFace v12.0 & ZKFinger v10.0 & ZKPalm V12.0
- Fingerprint: FAR≤0.0001%; FRR≤0.01%
- Face: FAR≤0.001%; FRR≤1%
- Palm: FAR≤0.01%; FRR≤1%

Power

- Operating Voltage 12V DC
- Current Draw < 500 mA

Configuration

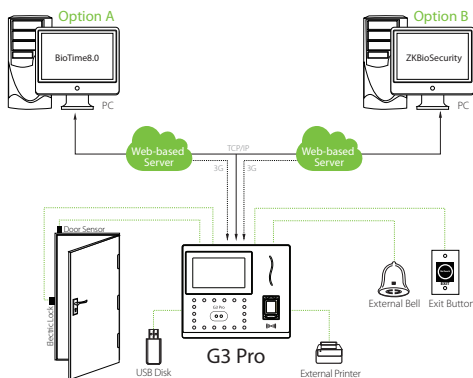

Dimensions (mm)

